

SUC 200

AÇO INOXIDÁVEL
rolamento ESFÉRICO
fixação por PARAFUSOS
serviço NORMAL

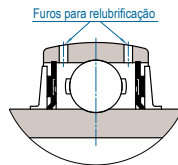
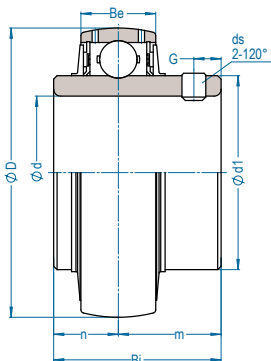

| Rolamento Série SUC | Eixo | | Dimensão nominal (mm) | | | | | | | ds (mm) (UNF) | Cargas (kgf) | | Peso (kg) | Rotação Máxima (rpm) Ajuste h7 |
|---|--------------------------|------------------|-----------------------|-------|------|------|------|------|------|---------------------|-------------------|----------------------|--------------|---|
| | \varnothing pol | \varnothing mm | D | d1 | Bi | n | m | Be | G | | dinâmica C_r | estática C_{or} | | |
| SUC 204-12 V22 SUC 204 V22 | 3/4 | 20 | 47,0 | 29,0 | 31,0 | 12,7 | 18,3 | 17,0 | 5,0 | M6x1 1/4-28 | 990 | 665 | 0,20 | 4800 |
| SUC 205 V22 SUC 205-16 V22 | 1 | 25 | 52,0 | 34,0 | 34,1 | 14,3 | 19,8 | 17,0 | 5,0 | M6X1 1/4-28 | 1080 | 788 | 0,20 | 4000 |
| SUC 206-18 V22 SUC 206 V22 SUC 206-19 V22 SUC 206-20 V22 | 1-1/8 1-3/16 1-1/4 | 30 | 62,0 | 40,5 | 38,1 | 15,9 | 22,2 | 19,0 | 5,0 | M6x1 1/4-28 | 1500 | 1120 | 0,30 | 3400 |
| SUC 207-20 V22 SUC 207 V22 SUC 207-23 V22 | 1-1/4 1-7/16 | 35 | 72,0 | 48,0 | 42,9 | 17,5 | 25,4 | 20,0 | 7,0 | M8X1 5/16-24 | 1980 | 1520 | 0,50 | 3000 |
| SUC 208-24 V22 SUC 208 V22 | 1-1/2 | 40 | 80,0 | 53,0 | 49,2 | 19,0 | 30,2 | 21,0 | 8,0 | M8x1 5/16-24 | 2230 | 1820 | 0,65 | 2600 |
| SUC 209-27 V22 SUC 209-28 V22 SUC 209 V22 | 1-11/16 1-3/4 | 45 | 85,0 | 57,0 | 49,2 | 19,0 | 30,2 | 22,0 | 8,0 | M8X1 5/16-24 | 2520 | 2080 | 0,70 | 2400 |
| SUC 210 V22 SUC 210-32 V22 | 2 | 50 | 90,0 | 62,0 | 51,6 | 19,0 | 32,6 | 24,0 | 10,0 | M10x1,25 3/8-24 | 2690 | 2320 | 0,80 | 2200 |
| SUC 211-32 V22 SUC 211 V22 SUC 211-35 V22 | 2 2-3/16 | 55 | 100,0 | 69,0 | 55,6 | 22,2 | 33,4 | 25,0 | 10,0 | M10x1,25 3/8-24 | 3330 | 2920 | 1,15 | 2000 |
| SUC 212 V22 SUC 212-39 V22 | 2-7/16 | 60 | 110,0 | 75,0 | 65,1 | 25,4 | 39,7 | 27,0 | 10,0 | M10x1,25 3/8-24 | 4020 | 3280 | 1,55 | 1800 |
| SUC 213 V22 | | 65 | 120,0 | 82,0 | 65,1 | 25,4 | 39,7 | 28,0 | 12,0 | M10x1,25 | 4390 | 4000 | 1,75 | 1700 |
| SUC 214 V22 | | 70 | 125,0 | 86,5 | 74,6 | 30,2 | 44,4 | 30,0 | 12,0 | M12x1,25 | 4760 | 4500 | 2,00 | 1600 |
| SUC 215 V22 SUC 215-48 V22 | 3 | 75 | 130,0 | 91,5 | 77,8 | 33,3 | 44,5 | 30,0 | 12,0 | M12x1,25 | 5060 | 4950 | 2,20 | 1500 |
| SUC 216 V22 SUC 216-51 V22 | 3-3/16 | 80 | 140,0 | 98,0 | 82,6 | 33,3 | 49,3 | 33,0 | 14,0 | M12x1,25 | 5550 | 5420 | 2,80 | 1400 |
| SUC 217 V22 SUC 217-55 V22 | 3-7/16 | 85 | 150,0 | 105,0 | 85,7 | 34,1 | 51,6 | 35,0 | 14,0 | M12x1,25 | 6370 | 6380 | 3,55 | 1300 |
| SUC 218 V22 | | 90 | 160,0 | 111,0 | 96,0 | 39,7 | 56,3 | 37,0 | 14,0 | M12x1,25 | 7310 | 7150 | 4,50 | 1200 |