

UCX 00

rolamento ESFÉRICO
fixação por PARAFUSOS
serviço PESADO

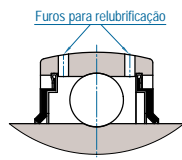
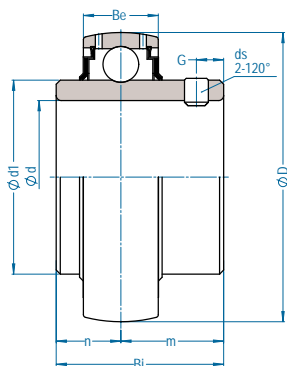

Rolamento	Eixo		Dimensão nominal (mm)							ds (mm) (UNF)	Cargas (kgf)		Peso (kg)
	Ø pol	Ø mm	D	d1	Bi	n	m	Be	G		dinâmica C _r	estática C _{or}	
UCX 05-15 V22 UCX 05 V22 UCX 05-16 V22	15/16 1	25	62,0	40,5	38,1	15,9	22,2	19,0	6,0	M6x1 1/4-28	2000	1140	0,35
UCX 06 V22 UCX 06-19 V22	1-3/16	30	72,0	48,0	42,9	17,5	25,4	20,0	6,5	M8x1 5/16-24	2640	1550	0,55
UCX 07 V22 UCX 07-23 V22	1-7/16	35	80,0	53,0	49,2	19,0	30,2	21,0	8,0	M8x1 5/16-24	2990	1860	0,75
UCX 08-24 V22 UCX 08 V22	1-1/2 40	40	85,0	57,0	49,2	19,0	30,2	22,0	8,0	M8x1 5/16-24	3350	2120	0,85
UCX 09-27 V22 UCX 09-28 V22 UCX 09 V22	1-11/16 1-3/4 45	45	90,0	62,0	51,6	19,0	32,6	23,0	9,0	M10x1,25 3/8-24	3600	2370	0,90
UCX 10-31 V22 UCX 10 V22	1.15/16 50	50	100,0	69,0	55,6	22,2	33,4	25,0	9,0	M10x1,25 3/8-24	4400	2980	1,25
UCX 11 V22 UCX 11-35 V22	55 2-3/16	55	110,0	75,0	65,1	25,4	39,7	27,0	10,5	M10x1,25 3/8-24	5350	3350	1,70
UCX 12 V22	60	60	120,0	82,0	65,1	25,4	39,7	28,0	12,0	M12x1,25	5850	4080	1,95
UCX 13-600 V22 UCX 13-39 V22 UCX 13-40 V22 UCX 13 V22	2-7/16 2-1/2 65	65	125,0	86,5	74,6	30,2	44,4	30,0	12,0	M12x1,25 7/16-20	6350	4590	2,60
UCX 14-650 V22 UCX 14-43 V22 UCX 14 V22	2-11/16 70	70	130,0	91,5	77,8	33,3	44,5	30,0	12,0	M12x1,25 7/16-20	6750	5050	2,75
UCX 15-47 V22 UCX 15 V22 UCX 15-48 V22	2-15/16 3 75	75	140,0	98,0	82,6	33,3	49,3	33,0	14,0	M12x1,25 7/16-20	7400	5530	3,10
UCX 16 V22 UCX 16-51 V22	3-3/16 80	80	150,0	105,0	85,7	34,1	51,6	35,0	14,0	M12x1,25 7/16-20	8500	6510	3,80
UCX 17 V22 UCX 17-55 V22	3-7/16 85	85	160,0	111,0	96,0	39,7	56,3	37,0	14,0	M12x1,25 7/16-20	9750	7300	4,80
UCX 18 V22	90	90	170,0	118,0	104,0	42,9	61,1	39,0	14,0	M14x1,5	11100	8400	5,50
UCX 20 V22 UCX 20-63 V22 UCX 20-64 V22	3-15/16 4 100	100	190,0	130,5	117,5	49,2	68,3	44,0	16,0	M16x1,5 5/8-18	13500	10000	9,05