

UC 200 HT2 (L)

rolamento ESFÉRICO
fixação por PARAFUSOS
serviço NORMAL
ALTA TEMPERATURA

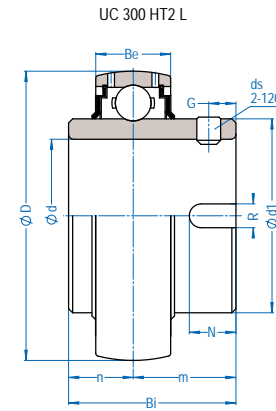
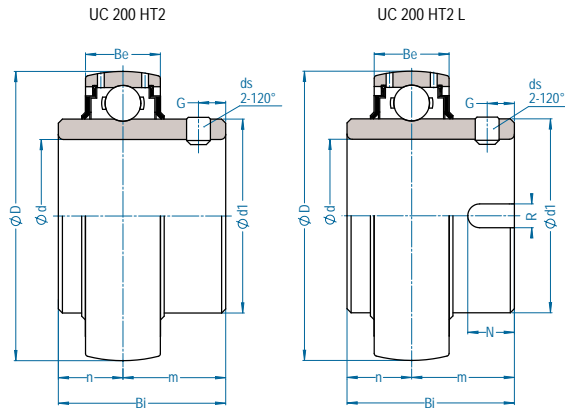

UC 300 HT2 L

rolamento ESFÉRICO
fixação por PARAFUSOS
serviço NORMAL
ALTA TEMPERATURA



Rolamento	Eixo		Dimensão nominal (mm)								ds (mm) (UNF)	Cargas (kgf)		Peso (kg)	máxima (rpm) ajuste h7	
	Ø pol	Ø mm	D	d1	Bi	n	m	Be	G	(N)		(R) HT1	dinâmica C _r			estática C _{or}
UC 204-12 HT2 V22 UC 204 HT2 V22(L)	3/4	20	47,0	29,0	31,0	12,7	18,3	16,0	4,7	-	-	M6x1 1/4-28	1310	680	0,20	3800
UC 205 HT2 V22(L) UC 205-16 HT2 V22	1	25	52,0	34,0	34,0	14,3	19,7	17,0	5,5	(7,5)	(7,0)	M6x1 1/4-28	1430	800	0,20	3000
UC 206 HT2 V22(L)		30	62,0	40,5	38,1	15,9	22,2	19,0	5,5	(8,2)	(7,0)	M6x1	2000	1140	0,30	2500
UC 207 HT2 V22(L)		35	72,0	48,0	42,9	17,5	25,4	20,0	6,5	(11,4)	(7,0)	M8x1	2640	1550	0,50	2100
UC 208 HT2 V22(L)		40	80,0	53,0	49,2	19,0	30,2	21,0	8,0	(12,2)	(7,0)	M8x1	2990	1860	0,65	1900
UC 209-28 HT2 V22 UC 209 HT2 V22(L)	1-3/4	45	85,0	57,0	49,2	19,0	30,2	22,0	8,0	(13,7)	(7,0)	M8x1 5/16-24	3350	2120	0,70	1700
UC 210 HT2 V22(L)		50	90,0	62,0	51,6	19,0	32,6	23,0	9,0	(12,4)	(7,0)	M10x1,25	3600	2370	0,80	1500
UC 211-32 HT2 V22 UC 211 HT2 V22(L)	2	55	100,0	69,0	55,6	22,2	33,4	25,0	9,0	(12,4)	(7,0)	M10x1,25 3/8-24	4400	2980	1,15	1400
UC 212 HT2 V22(L)		60	110,0	75,0	65,1	25,4	39,7	27,0	10,5	(14,4)	(9,0)	M10x1,25	5350	3350	1,55	1300
UC 213 HT2 V22(L)		65	120,0	82,0	65,1	25,4	39,7	28,0	12,0	(14,4)	(9,0)	M12x1,25	5850	4080	1,75	1200
UC 214 HT2 V22(L)		70	125,0	86,2	74,6	30,2	44,4	30,0	12,0	(15,2)	(9,0)	M12x1,25	6350	4590	2,00	1100
UC 215-47 HT2 V22(L) UC 215 HT2 V22	2-15/16	75	130,0	91,5	77,8	33,3	44,5	30,0	12,0	(15,2)	(9,0)	M12x1,25 7/16-20	6750	5050	2,20	1000
UC 216 HT2 V22		80	140,0	98,0	82,6	33,3	49,3	33,0	14,0	-	-	M12x1,25	7400	5530	2,80	940
UC 218 HT2 V22		90	160,0	111,0	96,0	39,7	56,3	37,0	14,0	-	-	M12x1,25	9750	7300	4,50	830

Rolamento Série UC	Eixo Ømm	Dimensão nominal (mm)								ds (mm) (UNF)	Cargas (kgf)		Peso (kg)	máxima (rpm) ajuste h7	
		D	d1	Bi	n	m	Be	G	(N)		(R) HT1	dinâmica C _r			estática C _{or}
UC 308 HT2 V22 L	40	90,0	56,5	52,0	19,0	33,0	28,0	10,0	12,2	7,0	M10x1,25	4140	2450	1,00	1800
UC 310 HT2 V22 L	50	110,0	69,0	61,0	22,0	39,0	32,0	12,0	12,4	7,0	M12x1,25	6300	3860	1,30	1400
UC 312 HT2 V22 L	60	130,0	81,0	71,0	26,0	45,0	36,0	12,0	14,4	9,0	M12x1,25	8330	5290	2,60	1200
UC 318 HT2 V22 L	90	190,0	120,0	96,0	40,0	56,0	48,0	16,0	20,0	12,0	M16x1,5	15490	11020	7,95	425

Sistemas de expansão axial do eixo disponíveis para rolamentos UC HT2 FRM.
Para maiores informações consulte descritivo técnico na página 248:

1- W5

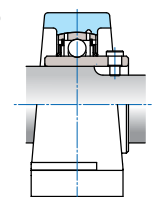

2- W6

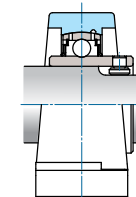

3- Pino de Arraste

