

FS 300

mancal tipo FLANGE
serviço PESADO

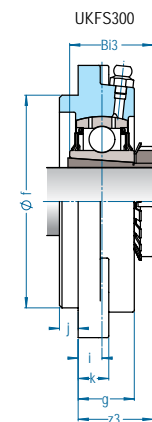

Caixa	Eixo		Dimensão nominal (mm)										Paraf.	Peso (kg)				D	Rolamentos							
	Ø pol	Ø mm	a	e	i	s	j	k	g	f	t	Zc		YFS3	CYFS3 C(E)	GFS3	UKFS3		Y 300	G 300	UK 300					
																	z1	B11	z2	B12	Ø Eixo	Bucha	z3	B13		
FS 305	1	25	110	80,0	9,0	16,0	7	13	22	80,0	2	46	M14 1/2	1,30	1,80	1,40	1,30	62,0	32	38,0	39,0	46,8	3/4 20	HE2305 H2305	30	35,0
FS 306	1-3/16	30	125	95,0	10,0	16,0	8	15	24	90,0	2	51	M14 1/2	2,00	2,40	2,10	1,90	72,0	36	43,0	43,0	50,0	7/8 15/16 25 1	HS2306 HA2306 H2306 HE2306	33	38,0
FS 307	1-1/4 1-7/16	35	135	100,0	11,0	19,0	9	16	27	100,0	3	58	M16 5/8	2,30	2,80	2,30	2,30	80,0	40	48,0	44,0	51,6	1-1/8 30 1-3/16	HS2307 H2307 HA2307	36	43,0
FS 308	1-1/2	40	150	112,0	13,0	19,0	10	17	30	115,0	3	65	M16 5/8	3,10	3,70	3,20	2,90	90,0	46	52,0	50,0	57,1	1-1/4 1-5/16 1-3/8 35	HE2308 HA2308 HS2308 H2308	40	46,0
FS 309	1-11/16 1-3/4	45	160	125,0	14,0	19,0	11	18	33	125,0	3	68	M16 5/8	3,90	4,60	4,10	3,80	100,0	49	57,0	53,0	58,7	1-7/16 1-1/2 40 1-5/8	HA2309 HE2309 H2309 HS2309	44	50,0
FS 310	1-7/8 1-15/16	50	175	132,0	16,0	23,0	12	19	36	140,0	3	74	M20 3/4	4,80	5,60	5,00	4,50	110,0	55	61,0	58,0	66,6	1-11/16 1-3/4 45	HA2310 HE2310 H2310	48	55,0
FS 311	2 2-3/16	55	185	140,0	17,0	23,0	13	20	39	150,0	4	80	M20 3/4	5,50	6,90	5,90	5,40	120,0	58	66,0	62,0	73,0	1-7/8 1-15/16 50 2	HS2311 HA2311 H2311 HS2311	50	59,0
FS 312	2-1/4 2-5/16 2-7/16	60 65	195	150,0	19,0	23,0	14	22	42	160,0	4	89	M20 3/4	7,10	9,50	7,40	6,50	130,0	64	71,0	67,5	79,4	2-1/8 55	HS2312 H2312	55	62,0
FS 313	2-1/2	65	208	166,0	15,0	23,0	18	22	40	175,0	4	93	M20 3/4	8,80	11,30	9,20	8,20	140,0	60	75,0	68,0	-	2-3/16 2-1/4 60 2-3/8	HA2313 HE2313 H2313 HS2313	53	65,0

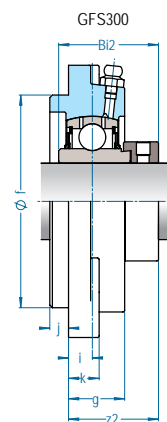
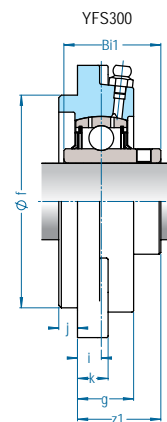
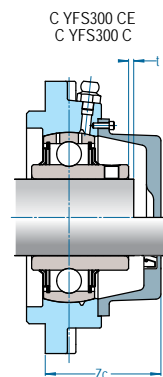
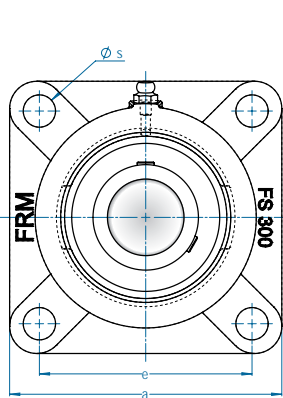

FS 300
mancal tipo FLANGE
serviço PESADO



Caixa	Eixo		Dimensão nominal (mm)										Paraf.	Peso (kg)				D	Rolamentos							
	Ø pol	Ø mm	a	e	i	s	j	k	g	f	t	Zc		YFS3	CYFS3 C(E)	GFS3	UKFS3		Y 300	G 300	UK 300		Ø Eixo	Bucha	z3	BI3
																	z1	BI1	z2	BI2						
FS 314	2-11/16	70	226	178,0	18,0	25,0	18	25	43	185,0	4	97	M22 7/8	11,30	14,40	11,90	-	150,0	65	78,0	76,0	92,1	-	-	-	-
FS 315	2-15/16 3	75	236	184,0	21,0	25,0	18	25	48	200,0	4	101	M22 7/8	12,50	16,20	13,60	12,00	160,0	71	82,0	84,0	100,0	2-1/2 65	HE2315 H2315	63	73,0
FS 316	3-3/16	80	250	196,0	18,0	31,0	20	27	48	210,0	4	105	M27 1	15,40	20,70	16,50	14,40	170,0	70	86,0	84,0	106,4	2-3/4 70	HE2316 H2316	62	78,0
FS 317	-	85	260	204,0	24,0	31,0	20	27	54	220,0	5	114	M27 1	16,90	21,50	-	15,40	180,0	80	96,0	-	-	75 3	H2317 HE2317	72	82,0
FS 318	3-7/16	90	280	216,0	24,0	35,0	20	30	56	240,0	5	109	M30 1-1/8	21,00	26,00	23,00	21,00	190,0	80	96,0	96,3	115,9	80	H2318	72	86,0
FS 319	-	95 100	290	228,0	39,0	35,0	20	30	74	250,0	5	129	M30 1-1/8	25,50	29,20	-	25,30	200,0	101	103,0	-	122,3	3-1/4 85	HE2319 H2319	91	90,0
FS 320	3-15/16 4	100	310	242,0	39,0	38,0	20	32	74	260,0	5	141	M33 1-1/4	28,00	35,80	29,90	27,70	215,0	105	108,0	117,6	128,6	3-1/2 90	HE2320 H2320	93	97,0
FS 322	-	110	340	266,0	35,0	41,0	25	35	71	300,0	5	135	M36 1-3/8	35,50	42,90	-	35,60	240,0	106	117,0	-	141,3	100 4	H2322 HE2322	96	105,0
FS 324	-	120	370	290,0	35,0	41,0	30	40	80	330,0	5	151	M36 1-3/8	47,40	57,20	-	46,90	260,0	110	126,0	-	-	110	H2324	100	112,0
FS 326	-	130	410	320,0	35,0	41,0	30	45	85	360,0	6	156	M36 1-3/8	71,00	84,00	-	61,00	280,0	116	135,0	-	-	115	H2326	103	121,0
FS 328	-	140	450	350,0	45,0	41,0	30	55	95	400,0	6	167	M36 1-3/8	87,70	104,20	-	88,10	300,0	131	145,0	-	-	125	H2328	116	131,0